

Bestway[®]

P3149

www.bestwaycorp.com

OWNER'S MANUAL

IMPORTANT SAFETY INSTRUCTIONS

READ AND FOLLOW ALL INSTRUCTIONS.

Carefully read, understand, and follow all information in this user manual before installing and using the air mattress.

These warnings, instructions, and safety guidelines address some common risks, but they cannot cover all risks and dangers in all cases. Always use caution, common sense, and good judgement when enjoying the air mattress. Retain this information for future use. In addition, the following information can be supplied depending on the air mattress type. Safekeeping the instruction.

WARNING

- If the supply cord is damaged, it must be replaced by the manufacturer, its service agent or similarly qualified persons in order to avoid a hazard.
- Motor for short time operation only. Inflate only for 5 minutes and deflate only for 5 minutes. Make sure motor's run time at a time does not exceed 5 minutes.
- This appliance is not intended for use by persons (including children) with reduced physical, sensory or mental capabilities, or lack of experience and knowledge, unless they have been given supervision or instruction concerning use of the appliance by a person responsible for their safety. Children should be supervised to ensure that they do not play with the appliance.
- If instruction is missed, please contact with Bestway or search it in website: www.bestwaycorp.com

TECHNICAL INSTRUCTIONS

DUAL FUNCTION: INFLATION & DEFLATION EXCLUSIVELY DESIGNED FOR AIR BEDS.

READ CAREFULLY BEFORE OPERATING AND SAVE THESE INSTRUCTIONS.

TO AVOID THE RISK OF ELECTRIC SHOCK, DO NOT EXPOSE TO WATER OR RAIN.

- Unplug or disconnect the appliance from the power supply before using and servicing.
- The air vent on the cover should be kept free of debris during use.
- Product must be stored in a dry location.
- After use, airbeds may require additional air to increase firmness. Add air to proper firmness.
- This product is not intended for commercial use.
- Drawings for illustration purpose only. May not reflect actual product. Not to scale.

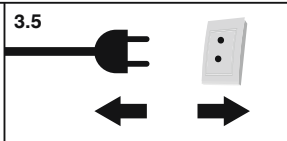
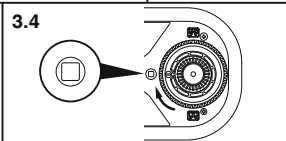
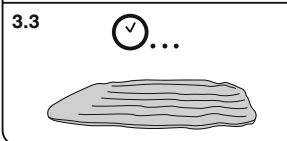
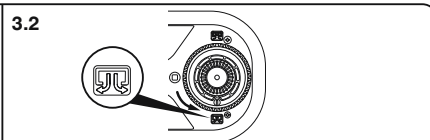
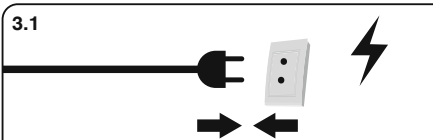
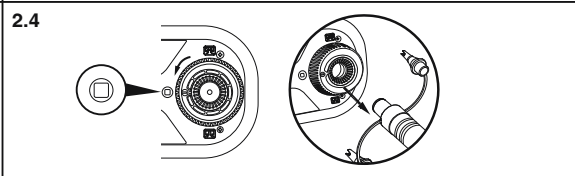
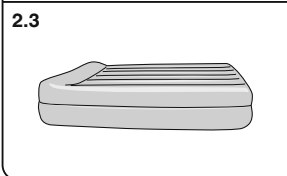
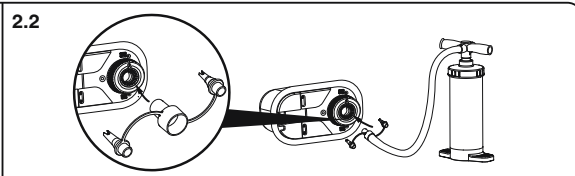
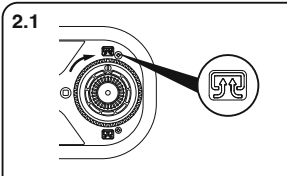
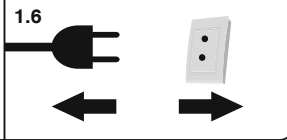
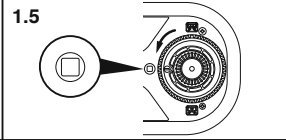
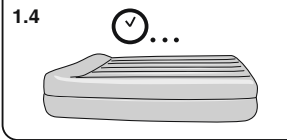
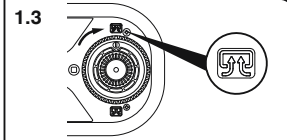
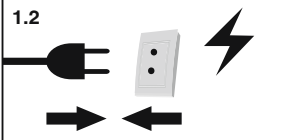
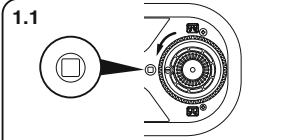
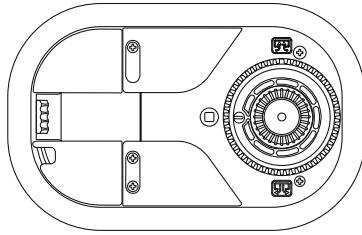



4.1

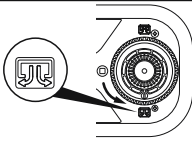

4.2

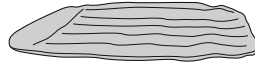

5.1

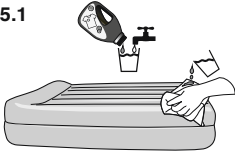

5.2

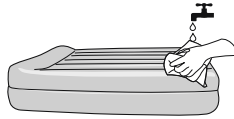

5.3

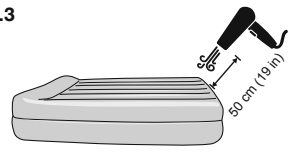

≥15°C/59°F

6.1

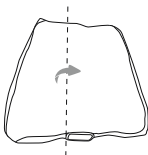

6.2



6.3



6.4

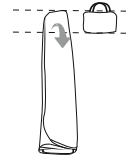

6.5



6.6

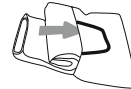

67486

1



2

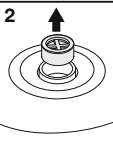

3

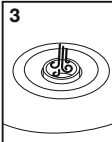

4

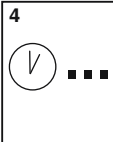

5



6

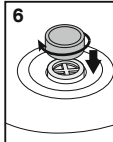

7

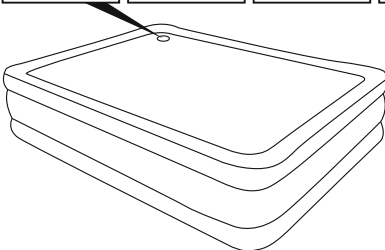
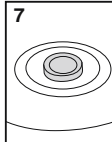

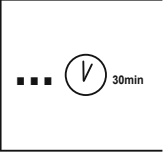
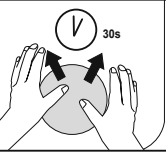
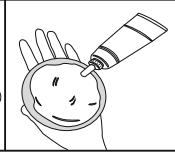
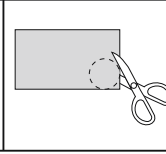
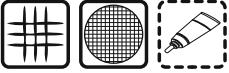
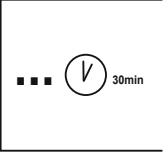
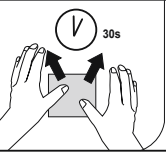
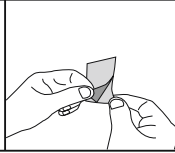
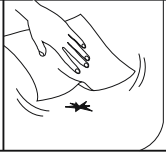
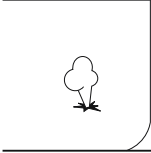

Bestway®

©2024 Bestway Inflatables & Material Corp.

All rights reserved / Tous droits réservés / Todos los derechos reservados / Alle Rechte vorbehalten / Tutti i diritti riservati

Trademarks used in some countries under license from / Marques déposées utilisées dans certains pays sous licence de / Marcas comerciales utilizadas en algunos países bajo licencia de / Marken, abweichend in bestimmten Ländern unter Lizenz von / I marchi commerciali sono utilizzati in alcuni paesi su licenza **Bestway Inflatables & Material Corp.**

Manufactured by / Fabriqué par / Fabricado por / Produziert von / Prodotto da **Bestway Inflatables & Material Corp., No. 208 Jin Yuan Wu Road, Shanghai, 201812, China.**

Exported by / Exporté par / Exportado por / Exportiert von / Esportato da **Bestway (Hong Kong) International Ltd./Bestway Enterprise Company Limited, Suite 713, 7/Floor, East Wing, Tsim Sha Tsui Centre, 66 Mody Road, Kowloon, Hong Kong.**

Manufactured for, distributed and represented in the European Union by / Fabriqué pour, distribué et représenté dans l'Union européenne par / Fabricado, distribuido y representado en la Unión Europea por / Hergestellt für Vertrieb sowie Vertretung innerhalb der Europäischen Union durch / Fabricato per conto di, distribuito e rappresentato nell'Unione Europea da **Bestway Europe S.p.a., Via Resistenza, 5, 20098 San Giuliano Milanese (Milano), Italy.**

Represented in United Kingdom by **Bestway Corp UK Ltd, 8 Wentworth Road, Heathfield Industrial Estate, Newton Abbot, Devon, TQ12 6TL.**

Represented in Latin America by / Représenté en Amérique latine par / Representado en Latinoamérica por / Representado na América Latina por **Bestway Central & South America Ltda, Salar Ascotan 1282, Parque Enea, Pudahuel, Santiago, Chile.**

Represented in Australia & New Zealand by **Bestway Australia Pty Ltd, Unit 2/98-104 Carnarvon St Silverwater, NSW 2128, Australia.**

(Tel: Australia: (+61) 2 9037 1388; New Zealand: 0800 142 101).

Represented in North America by / Représenté en Amérique du Nord par / Representado en Norteamérica por **Bestway (USA) Inc., 3435 S.**

McQueen Road, Chandler, AZ 85286, United States of America.

www.bestwaycorp.com